

# Electrophoresis Products

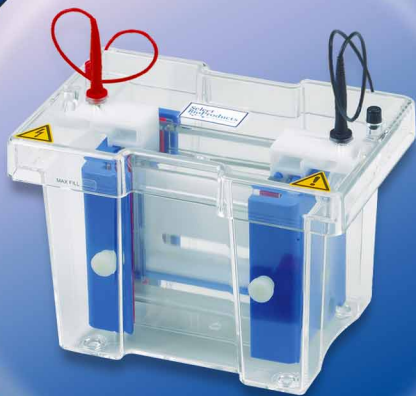

Mini Modular  
PAGE System

Submarine  
Gel Systems



BioVolt  
Power Supplies

## Select BioProducts Horizontal Electrophoresis Systems

- ☆ Molded, durable gel boxes and gel trays
- ☆ Rubber gates for tapeless gel casting
- ☆ "EasyLift" safety lid with buffer recapture system

Designed for ease of use and safe operation, the Select BioProducts Electrophoresis Systems and accessories are built to withstand the rigors of every day use.

All of the gel boxes and gel trays are molded of thick acrylic for leakproof performance. The gel trays are UV transparent for easy visualization of samples. The electrodes are protected by "cassettes" and are easily removed for cleaning and replacement.

Casting is simple and tape-free with the durable rubber casting gates. Slots in the sides of the trays allow for easy comb placement. The two piece design of the combs provides for vertical adjustment, giving the user control over the depth of the well. The combs supplied with the systems are 1.5 mm thick. Multiple combs, including those compatible with multichannel pipettors and different thicknesses, are available.

The "EasyLift" gel box lid is easily removed using the side tabs and pressure pads. The lid is domed, to prevent condensation from dripping onto the gel, and is surrounded by a drip ring, to help recover the condensate and maintain buffer concentration.

A variety of sizes are available, from the compact mini system to the large maxi system which will accommodate as many as 450 samples. A broad range of accessories are also available including various sizes of gel trays and combs, many of which are multichannel compatible.

Model	Mini 7	Mini 10	Midi 10	Midi Plus 10	Midi Plus 15	Maxi 20
Gel (WxL cm)	7 x 7	7 x 10	10 x 10	15 x 10	15 x 15	20 x 20
Unit (WxLxH cm)	9 x 21 x 9	9 x 21 x 9	12.5 x 22 x 9	17.5 x 26.5 x 9	17.5 x 26.5 x 9	23 x 39.5 x 9
Buffer volume	225 mL	225 mL	300 mL	500 mL	500 mL	1,200 mL
Maximum sample capacity	32	64	100	140	210	450
Supplied Combs	8 tooth (2)	8 tooth (3)	10* tooth (2)	16* tooth (1) 20 tooth (1)	16* tooth (1) 28* tooth (1) 20 tooth (1)	20 tooth* (2) 40 tooth* (2)
Catalog Number	<b>SBE1007-7</b>	<b>SBE1007-10</b>	<b>SBE1010-10</b>	<b>SBE1015-10</b>	<b>SBE1015-15</b>	<b>SBE1020-20</b>

\*Denotes multichannel compatible combs.

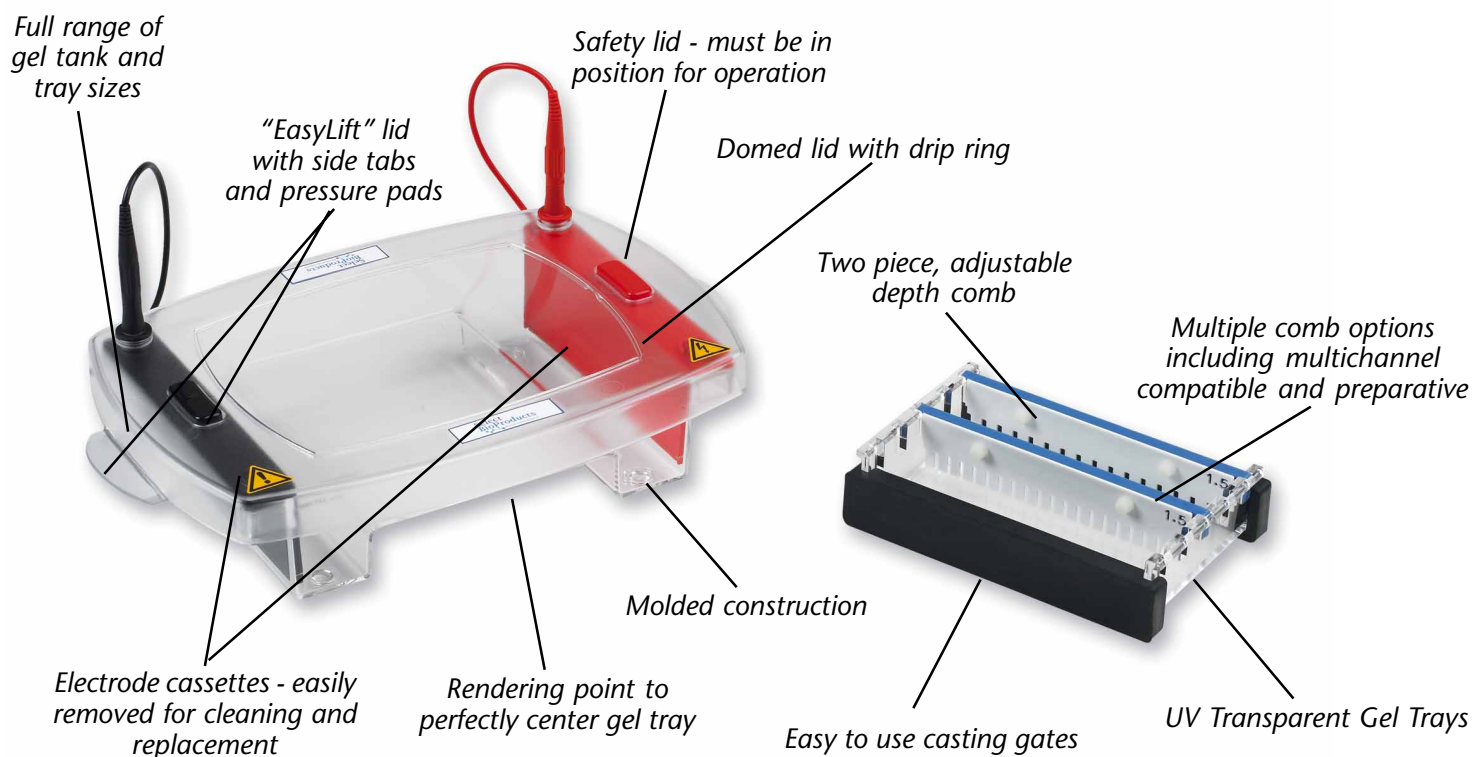

## Select BioProducts Mini 7

A true mini-gel system, the Mini 7 is designed for quick runs of low to medium numbers of samples. While its footprint is small, this unit will also accept a 10 cm long tray, allowing for larger numbers of samples or longer runs. Supplied with one 7 x 7 cm gel tray, well visualization strips and two 8 tooth combs



SBE1007-7

## Select BioProducts Mini 10

This mini-gel system comes complete with a 10 cm tray, maximizing the number of samples that can be run in a unit with a small footprint. Ideal for labs with medium throughput or for longer runs of smaller samples. Supplied with one 7 x 10 cm gel tray, well visualization strips and three 8 tooth combs.



SBE1007-10

## Select BioProducts Midi 10

With only a slightly wider footprint than the gel box above, this system holds more samples with a relatively low increase in buffer volume. Perfect for processing larger numbers of samples in short to medium runs, the Midi 10 is supplied with one 10 x 10 cm tray, well visualization strips and two 10 tooth multichannel compatible combs.



SBE1010-10

## Select BioProducts Midi Plus 10 and 15

Ideal for resolving close molecular weight samples and restriction fragments, these two systems feature multichannel combs make loading large numbers of samples quick and easy. Supplied with either a 15 x 10 or 15 x 15 cm gel tray and well visualization strips. The 10 cm unit is supplied with one 16 tooth and one 20 tooth comb. The 15 cm unit is supplied with one each of the 16 tooth, 20 tooth and 28 tooth combs.



With 15 x 10 cm tray  
SBE1015-10

With 15 x 15 cm tray  
SBE1015-15

## Select BioProducts Maxi 20

For laboratories processing large numbers of samples, such as PCR products from 96 well plates, RFLP analysis or plasmid screenings, the Maxi 20 is an ideal choice. The 20 cm width of the gel provides for high throughput screening of samples, while the 20 cm length provides for good resolution. The unit is supplied with one 20 x 20 cm gel tray, well visualization strips and two 20 tooth and two 40 tooth multichannel compatible combs.



SBE1020-20



## BioVolt Power Supplies

- ☆ Perfect partner for Select BioProducts Gel Boxes
- ☆ Designed for safety and performance
- ☆ Constant current, voltage or power modes

BioVolt Power Supplies meet a wide range of applications including DNA, RNA and protein electrophoresis, blotting and many others. Designed with safety in mind, they are loaded with the features that today's molecular biology applications demand.

Two models are available with voltage ranges to 300V and current ranges to 3000mA. Operating modes include constant voltage or constant current with automatic crossover. In addition, the Model 250V offers a constant power operating mode. Operation may be timed or continuous.

All parameters, including voltage, current, power (250V model) and time are easily set using the membrane keypad and displayed digitally on the back lit LCD. Programming is straightforward, simple, and allows setting up multiple voltage/current changes within a single program. Each unit includes four sets of color coded output terminals allowing multiple gels to be run from the same power supply.

BioVolt Power Supplies offer short circuit and over current/over voltage protection. No load and load change detection systems are also incorporated into the software for safety. Programming also includes an option for automatic recovery after a power failure.

With a compact design and small footprint, the BioVolt Power Supplies are lightweight and stackable to save space. For easy viewing and setting of parameters on the bench or on a shelf, the front of the power supply can be raised with the integral folding feet.

Model	300V	250V
Output Voltage Range/Increments	2-300V/1V	5-250V/1V
Output Current Range/Increments	4-500mA/1mA	10-3000mA/10mA
Output Power Range/Increments	90 watts max/na	1-300W/1W
Operating constant modes	current or voltage	current or voltage or power
Timer	1-999 minutes or continuous	1 minute to 99 h 59 min or continuous
Programmable	No	Yes
Dimensions (W x D x H)	19 x 25 x 8 cm	19 x 25 x 8 cm
Weight	2.2 kg/4.9 lbs	2.5 kg/5.6 lbs
Input Voltage	120V or 230V	120V or 230V
Catalog Number - 120V	SBE300	SBE250
- 230V, EU power cord	SBE300-2	SBE250
- 230V, UK power cord	SBE300-3	SBE250-3



## Select BioProducts Modular Mini Vertical PAGE Systems

- ☆ PAGE, Electroblotting and 2D Electrophoresis Modules
- ☆ Exceptionally easy gel casting
- ☆ Customizable accessories

Why purchase three different systems for protein electrophoresis, IEF and Western blotting when the Select BioProducts Modular Mini Vertical PAGE System will do them all. The system features inserts for each application and a common buffer tank in which to run them.

Each insert has its own electrode assembly which connects to the lid of the buffer tank. For safety, the power leads connect directly to the lid - when the lid is removed, power is disconnected from the system. The tank has a small pad that fits into position in the lid. This ensures that the lid is always properly placed and aids in its removal. The buffer tank is molded to prevent separation and leaking.

Inserts, accessories and running tanks are manufactured from quality materials to ensure a long life. A variety of spacers, combs and other accessories are available to customize the system. All spacers and combs are color coded to indicate thickness. Each system is supplied with a cooling pack for superior results during longer runs or quick runs at higher voltages. Three packages are available to meet your needs. Components may also be purchased separately.

Model	Mini PAGE System	Mini PAGE Electroblotting System	Mini PAGE Tube Gel System
Gel Dimensions	10 x 10 cm	NA	8 cm long
Capacity	2 gels/run*	3 gels/transfer	10 tubes/run
Maximum samples	20 per gel	NA	10 (1/gel)
Buffer tank (W x D x H)	19 x 13 x 15 cm	19 x 13 x 15 cm	19 x 13 x 15 cm
Buffer volume	250 mL	1200 mL	500 mL
Included items**	2 ea 10 x 10 notched plates 2 ea 10 x 10 plates w/spacers 2 ea 1 mm comb, 12 wells PAGE Module, casting base	3 ea blotting cassettes 6 ea fiber pads Blotting module	20 ea capillary tubes 20 ea tube supports 10 ea blocking plugs 2D module
Catalog Number	SBE2010-P	SBE2010-PB	SBP2010-P2

\*It is possible to run 4 gels by stacking the plates.  
\*\*Each system includes buffer tank, lid with leads and cooling pack. The Blotting and 2D Gel Systems also include the PAGE components.

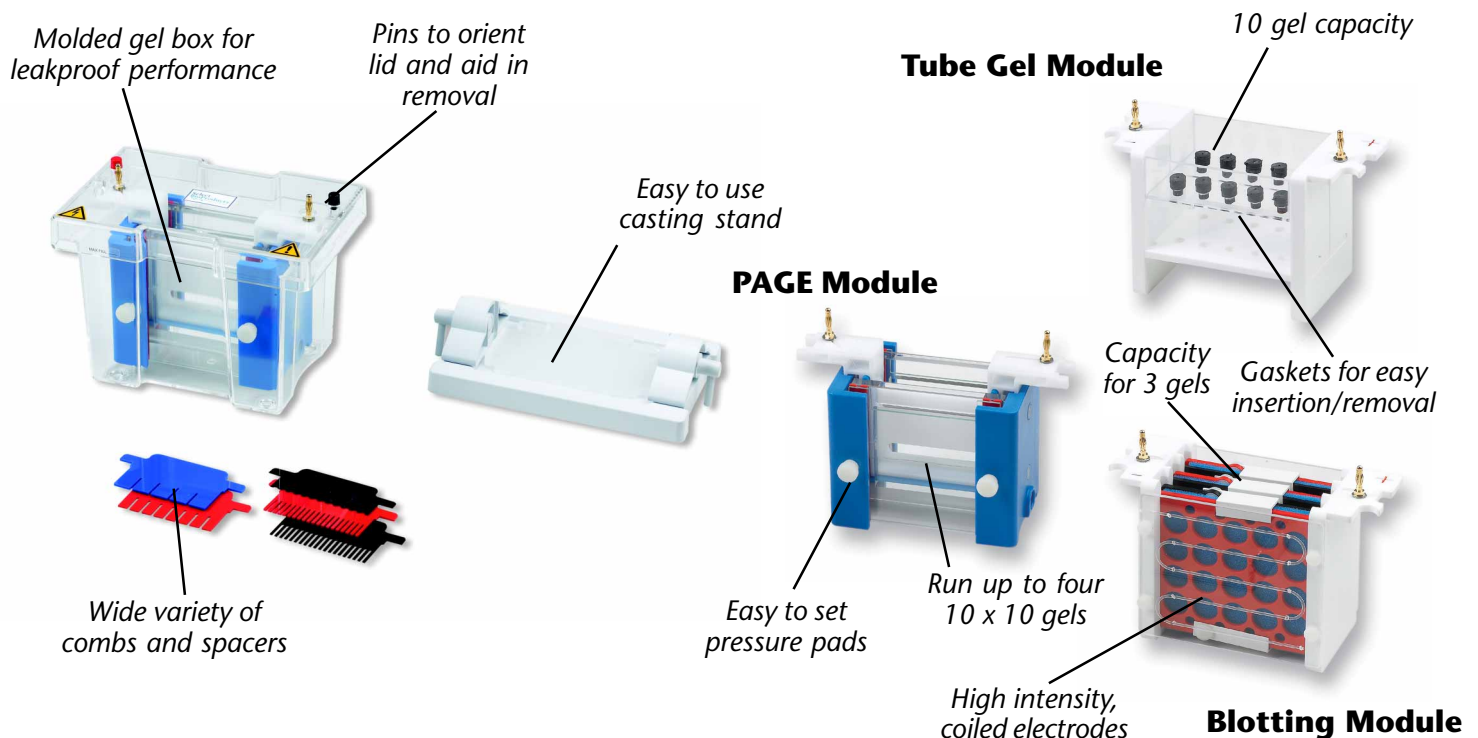

## Select BioProducts Mini Page System

Set up of 10 x 10 cm gels is easy with the Select BioProducts Mini PAGE System. Spacers are bonded to the glass plates. Before pouring the gel, the plates are placed in the gel insert and held in place by pressure frames. The insert is then placed in the casting stand. After the gel has polymerized, the insert is simply removed from the casting stand and placed in the buffer chamber. Each side of the insert will hold one set of plates. A third plate may be added to each set, allowing for a total capacity of four gels. The system is supplied with buffer tank, gel insert, casting stand, two notched plates, two plates with bonded spacers, two 1 mm x 12 tooth combs and a cooling pack.

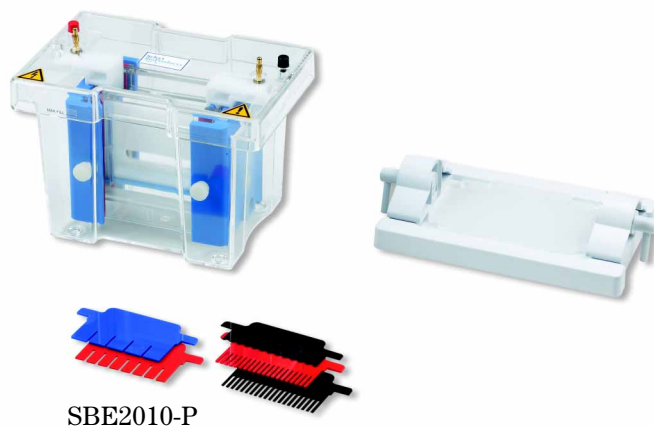

SBE2010-P

## Select BioProducts Mini PAGE Electroblotting System



SBE2010-PB

Three gels can be blotted quickly and easily with the Select BioProducts Mini PAGE Electroblotting System. Gels are sandwiched snugly in the blotting cassettes which are placed into the blotting insert. Coiled electrodes within the insert generate a high intensity current, allowing a standard transfer to take place in about an hour. The system includes the blotting insert, three blotting cassettes, six fiber pads and all of the components of the Select BioProducts Mini PAGE system listed above.

## Select BioProducts Mini PAGE Tube Gel System

The insert included in the VWR Mini PAGE Tube Gel System has a capacity for 10 first dimension gels. Gel ports are gasketed for easy insertion and removal of tubes. Included in the system are the tube gel insert, 10 blanking caps, 20 disposable capillary tubes, 20 tube gel supports and all of the components of the VWR Mini PAGE system above.



SBE2010-T2

**Select**  
**BioProducts**  
For Life Science Research

Email: [sales@selectbioproducts.com](mailto:sales@selectbioproducts.com)  
[www.selectbioproducts.com](http://www.selectbioproducts.com)